

TANITA

Digital Scale

for kitchen use

MODEL KJ-210M

EN

Important

Use the scale on a firm, flat surface.

1. The scale is a precision instrument. Do not dismantle the scale and avoid strong vibrations or shocks.
2. Keep away from direct sunlight and heating appliances, eg. oven.
3. When moving the scale to a new location, where the temperature differs from the previous location by more than 10°C (50°F), leave the scale in the new location for at least 2 hours before using it.
4. Wipe the scale clean with a damp cloth.
5. Avoid using chemicals to prevent creating a hazard.
6. If the scale is not to be used for a long period of time, remove the batteries.

Name of parts

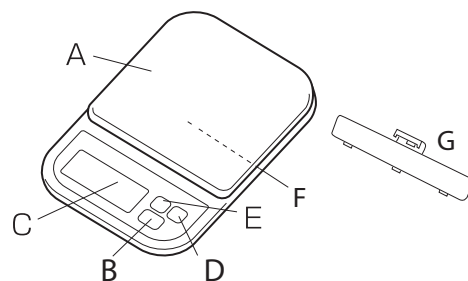

A	Tray
B	ON/ OFF button
C	LCD
D	Tare button
E	Rice calories button
F	Lid (Battery compartment)
G	Battery compartment

How to use

Battery placement

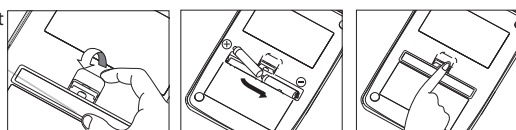

Insert 2×“AAA” “R03” or “24F” batteries as indicated.

Weighing/ Tare function

- Do not place anything on the weighing tray when turning on the power

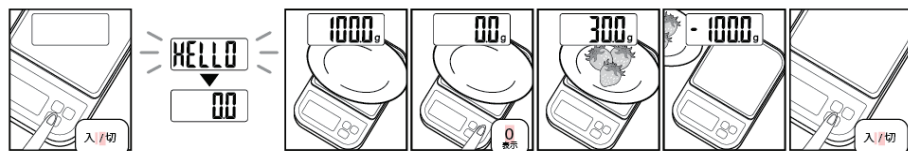

Press ON/OFF. Around 2 seconds Place the container on the tray. Place TARE to subtract the weight of the container. Place the material to be weighed. After removing the container, the display will show a negative reading. Press the TARE to return the display to “0”. Press ON/OFF to turn off.

If the weight of the item(s) exceeds the scale's capacity, “EEEE” will appear on the display. Make sure item (s) is placed in the center of the tray.

Auto power off

The scale is designed with an auto power-off function for energy efficiency. If the same reading is displayed for more than 6 minutes the scale will automatically turn off.

The power doesn't turn on

If “Lo” appears in the display when attempting to weigh, replace the battery (following previous instructions).

Unit switching

Besides normal weight (g), calories can be calculated based on the weight.

After pressing the rice calorie button, it will display the calories.

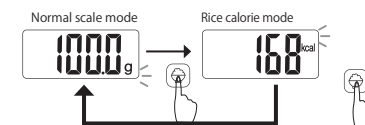

Rice calorie mode function

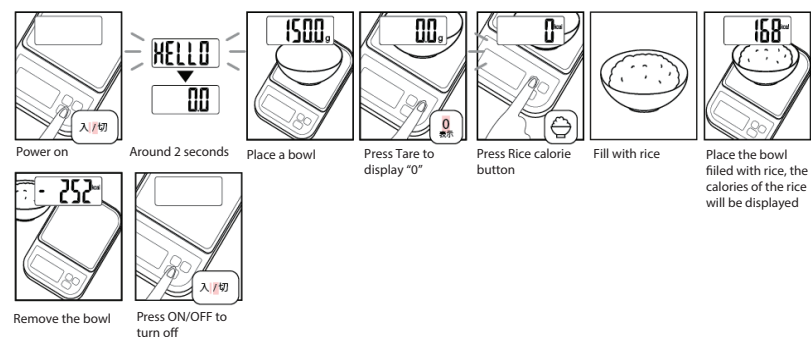

Trouble shooting

- The power doesn't turn on.
Insert 2 new size AAA (“R03” or “24F”) batteries. Be sure that the polarity of the batteries is set properly.
- “Err6” or “Err7” appears on the display.
The scale needs to be repaired. Please contact your retailer.
- “Err1” or “Err8” appears on the display.
Place the container or item(s) only after 0 g/0.00 oz is displayed.

Specification

	g version
Capacity	2000 g
Graduation	1 g

	kcal version
Maximum display	3360 kcal
Normal measurement unit	2 kcal